

RESIDENTIAL PROJECTS

Whether new build or refurbishment; conservation area or busy high street; each project presents a set of unique challenges and requires a corresponding skill set. Our expertise in dealing with statutory and planning obligations and our ability to advise on environmental sustainability adds value to each project. In each case we work closely with our client to understand their needs and we work creatively with what we find on the site to provide a design that is responsive, economical and delightful.

Glebe Cottage



Located in Maughold, an exposed and rugged peninsular on the Isle of Man, this project proposed the complete remodelling and extension of an existing, poorly converted 19th century mining building to create a modern family home. The client was concerned that the design enable and support their active and creative lifestyles, with space for a large workshop and studio; whilst allowing them to be as self-sufficient as possible. The use of local materials and energy saving design were also priorities.

The proposal included the demolition of the 'add-ons' that have accumulated over time, returning the building to its earlier footprint. This section of the project would be used as visitor accommodation, whilst two new wings would be built to house a new home for the couple. The buildings on the site would sit as a cluster around a central courtyard, a form common to farmsteads on the Island. The new wings would be similarly scaled to sit harmoniously with the existing masonry buildings - section and profiles should mirror that of the existing cottages. A basement would be added beneath the site to provide the necessary accommodation within a limited building footprint.

A key concern was to reduce the visual impact of the proposed new buildings on the landscape whilst creating a protected and sheltered living environment on this exposed peninsular and maximising light and views available.

Photomontage of proposed massing superimposed onto views of the site (above); 3D sketch of proposed (above right); Sequential diagrams showing the evolution of the buildings over time (right).

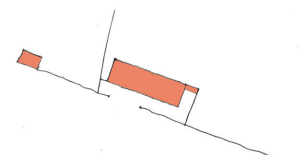
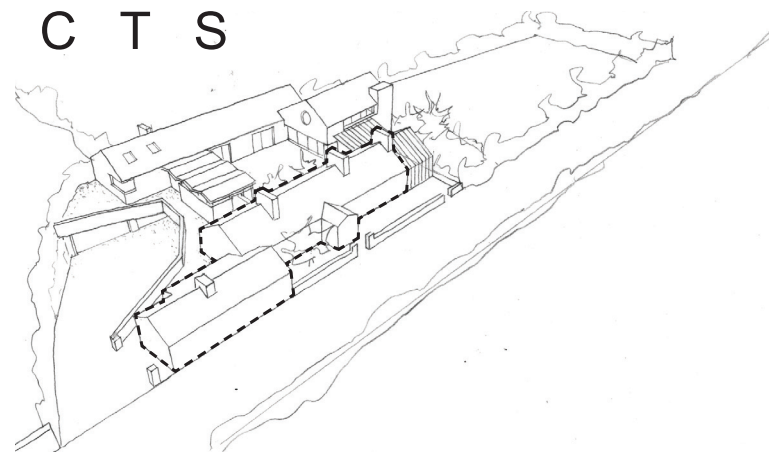
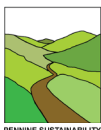

1870 - The building functions as a mining office and pre-dates many others in the village.



1988 - The building has been converted into a house, with a linear extension along the road.



2010 - A series of lean-to, ad-hoc additions have created a confused maze-like layout.



Proposed - The structure of the building from its conversion into a cottage is to be retained and a new 'wing' added, creating a courtyard.

Key Details

Architect: Project Architect Catherine Skelcher (for Cottrell and Vermeulen Architecture)
Design Completed to RIBA Stage C: 2010