

# E D U C A T I O N   A N D   C O M M U N I T Y

*Pennine Sustainability has experience of successfully designing/delivering a number of projects within the educational and community sectors. 'Landscapes for learning' should be creative, inspiring and supportive. Both the process of design and construction as well as the architecture realised can act as an educational tool for the school community. The 'extended school' and all that it can offer has become the new heart of the community.*

## Goodrich Primary School - Dulwich, London



Goodrich Primary School is a 3-form entry primary school in Southwark. The school provides a creative and stimulating learning environment and a focus for the community. However it suffers from a constricted site and its modern teaching is hampered by the Edwardian Buildings.

Tisdall Brougham Architects were approached to investigate ways in which the environs of the school might be developed to more effectively and creatively support its activities. A series of consultation events were held that ran along side the development of a masterplan for the school site. Through a series of meetings, workshops and assemblies two areas of focus emerged.

### 1. Security

The first task was to assess the entry sequence at different times of the day and propose solutions to maintain the open and welcoming nature of the school whilst improving security. A new entrance was proposed that would address this whilst acting as a gallery for the school.

### 2. Canopies

The canopies are conceived as shelters, gardens, classrooms, meeting places, weather stations, curriculum tools, dining areas, play spaces, and climbing frames etc. This simple device provides a catalyst for the imagination of the children and the community.

The aim of these proposals was to integrated the curriculum into the outside spaces in an entertaining, imaginative and stimulating way.

*Sketch Model & Play Shelter Detailed Plan (below); Photograph of completed Play Shelter (left).*

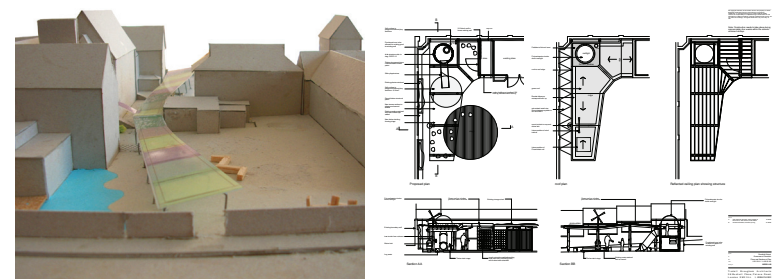

### Key Details

Architect: Tisdall Brougham Architecture;  
Play Shelter Completed: 2008

